

Jansen Art'15

Stylish design for luxury interiors



A new steel profile system for luxury living

Jansen Art'15 is the result of years of collaboration with Europe's top architects. World-class designers make extensive use of Jansen steel windows, doors and façades to create truly unique buildings. Jansen Art'15 is an exclusive addition to these elegant profile systems for use in private homes, offering interior design of the highest quality. The non-insulated steel profile system is perfect for the interior design of both existing buildings and newbuilds, and provides owners, architects and metal fabricators with space for their creative ideas.







Hof Souburgh Alblasterdam, ©Fotografie Lisette VD Pavoordt

Experience space the sophisticated way

Space and light are important features which create a feeling of 'home'. When breathtaking rooms are divided by partition walls which merge seamlessly into one another, you can enjoy total comfort at home. The reduced external face widths of Jansen Art'15 ensure a unique design and set new standards for the interior too. The Art'15 double doors add an exclusive touch to your home and create a feeling of space like no other.





Stadtvilla Rotterdam, ©tim van de velde tvdv photography

Transparency and aesthetic appeal for a feeling of space

Inspired by "Haute Couture" and "Haute Cuisine", the unique world of "Haute Design" can be experienced with the slimline profiles of Jansen Art'15 profiles. These doors can be completely sealed and thereby create the perfect balance between aesthetics and comfort. The improved sound reduction of up to 44dB for fixed glazing and 37dB for a single leaf doors as well as odour protection properties provide a whole new level of comfort, shutting out disruptive sounds and smells from other rooms.

You can enjoy a breathtaking and transparent sense of space and feel more comfortable in your home. Jansen Art'15 doors and partitions separate the entrance hall from the living space, the kitchen from the dining area, or the home office from the living room, without the generous amount of space being compromised.

Style and comfort become part of your every day

The non-insulated profile system for interiors expands the creative freedom of ambitious architects in stylish homes, shops and commercial spaces. The acoustic properties of steel and the sophisticated door technology create the perfect balance between transparency and privacy.







Slimline steel profiles of the highest quality

Jansen Art'15 offers the perfect combination of material and efficiency. Its wide variety is perfect for renovating a modern residential construction. With the narrowest profile face widths of only 25 to 40 mm for fixed glazing and a basic depth of 50 mm, intricate yet stable constructions can be created with a large proportion of glass and excellent thermal insulation.

The ecological and sustainable properties of steel create additional value for your home. Steel boasts positive characteristics such as stability and durability. The material can be reused any number of times and is therefore an environmentally responsible product. Steel guarantees longevity and is rightfully seen as a sustainable material.



Multifaceted design freedom

The traditional, handcrafted metalwork of Jansen Art'15 makes every product a unique piece. With Jansen Art'15, designs that are solid and durable can be made with modern opening types. Welded joints are not just strong, they also provide unrestricted design freedom. With Jansen Art'15, any design requirement can be met. Whether you're looking for a simple, industrial, traditional or playful style, you can create the perfect space with the perfect appearance and design to match your individual lifestyle.





Attractive living with stylish doors

Jansen Art'15 doors can be fully enclosed, allowing the door handle to take centre stage. Jansen Art'15 is manufactured by selected partners. These Jansen Art'15 partners will work with you to find the perfect product for your home. You can also receive tailored advice on sound reduction, design and customised door fittings.



Face-fitted profile view

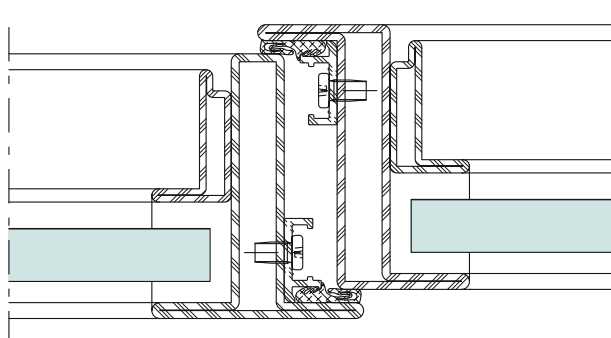

Rebated profile view

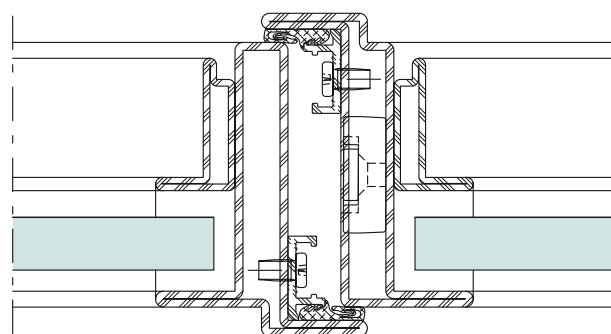

Flush-fitted profile view

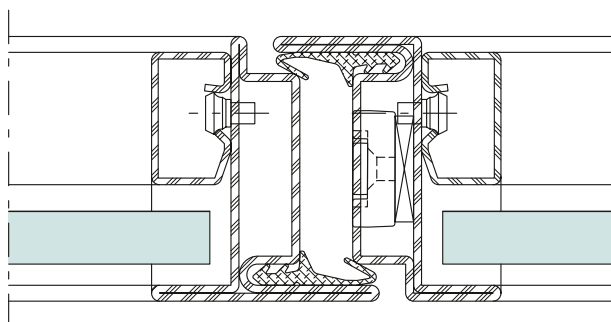

Range of profiles

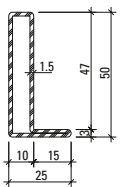

01.115

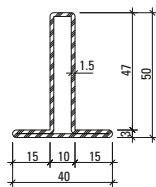

02.115

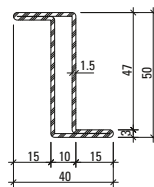

03.115

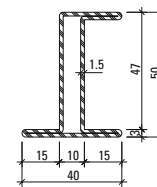

05.115

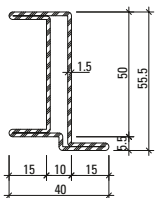

05.116

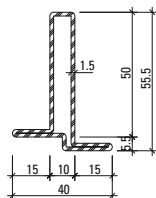

02.116

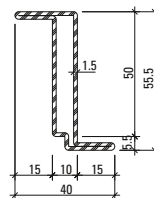

03.116

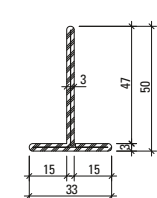

400.020

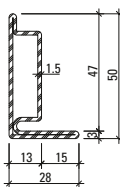

30.005

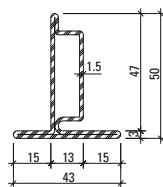

30.105

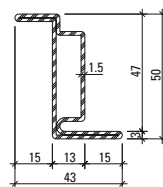

30.405

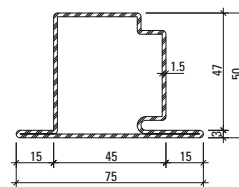

30.109

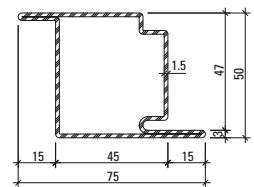

30.409

Glazing beads

Steel

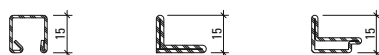

Aluminium



Schüco Jansen Steel Systems

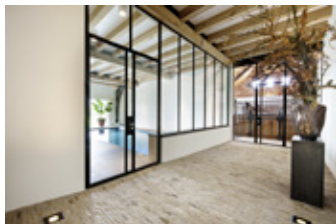

In partnership with Jansen AG, Schüco offers solutions for façade, door and window technology as well as security and safety constructions from high-quality steel tubes and steel profile systems throughout Europe. In this way, Schüco sets new standards in system expertise: architectural freedom, technological solutions for almost all requirements and efficient fabrication complement one another perfectly.

Schueco UK Limited

www.schueco.co.uk

Schüco – System solutions for windows, doors and façades

Based in Bielefeld, the Schüco Group develops and sells system solutions for windows, doors and façades. With 6330 employees worldwide, the company strives to be the industry leader in terms of technology and service both now and in the future. In addition to innovative products for residential and commercial buildings, the building envelope specialist offers consultation and digital solutions for all phases of a building project – from the initial idea through to design, fabrication and installation. Schüco works with 10,000 fabricators and 30,000 architectural practices, as well as construction professionals who commission buildings around the world. Founded in 1951, the company is now active in more than 80 countries and achieved a turnover of 1.995 billion euros in 2021. For more information, visit www.schueco.com

The 'Schüco' and other signs are protected in Germany and various international markets. We will provide detailed information upon request.

SCHÜCO
steel systems
JANSEN

P44659/ENV/01.2023/ Printed in the UK
We reserve the right to make technical changes and to correct errors. Products may differ from illustrations.

